

# RAPIDO DRIVES FOR RAPID DOORS

## DESCRIPTION

**RAPIDO** is made up of:

- A worm gear with hollow shaft
- An integrated safety brake
- An emergency manual operation
- Integrated limit switches
- An electric motor

All models are provided with an electromagnetic brake which stops suddenly the inertia of the motor.

## ADDITIONAL DETAILS

### EUROPEAN DIRECTIVES

RAPIDO is made in accordance with product standards EN 13241-1 Doors- and EN 12453 Safety for power operated doors.

### DUTY RATING

There is a relation between the weight of the door and the number of movements per hour so the motor duty rating varies according to the door weight.

### OVERLOAD SAFETY FACTOR

Motor overload safety factor = 4 x the nominal motor amperage because the starting current of the RAPIDO can reach these levels for short periods.

### OUTPUT SPEED

The maximum admissible speed depends on the construction and the door type. The admissible closing speed shall be tuned so to let the operating forces comply with the EN 12453.

### MANUAL OPERATION

Rapido is supplied with hand crank for manual operation when power cuts off.

# RAPIDO

Direct drive motors with integrated safety brake for rapid doors.

LP 50180  TM

LP 40130  TM

LP 60130  TM

LP 6090  TM

LP 7045  TM

---

LP 9090  TM

LP 12045  TM

---

LP 12590  TM

LP 25060  TM

#### Hollow shaft

Ø 30 mm\* (Standard)

V Ø 25 mm (Optional)

P Ø 25.4 mm (Optional)

\*for LP25060 available only 48 mm

#### Limit switch types

M Mechanical Limits

E Digital Limits

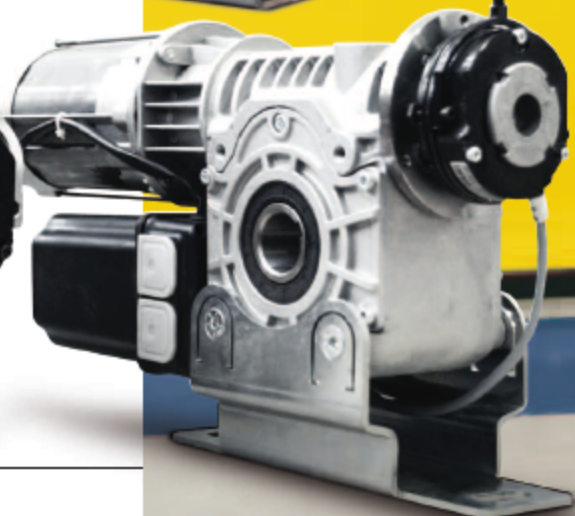
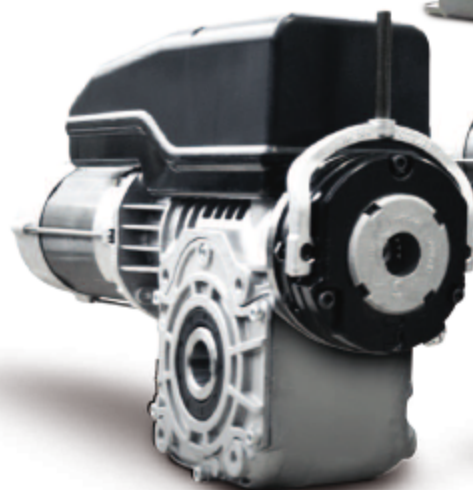

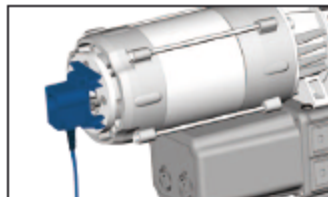

Hand crank

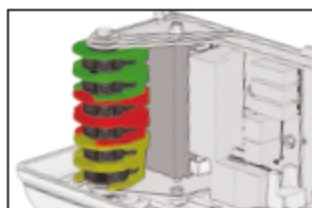

## Mechanical limits

- 2 Green cams for operating limits.
- 2 Red cams for safety limits.
- 2 Yellow cams for auxiliary controls

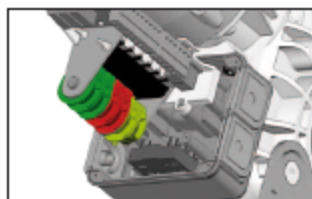

## Digital limits

Absolute encoder  
No readjustment after power failure  
(necessary if a control unit with inverter is used)

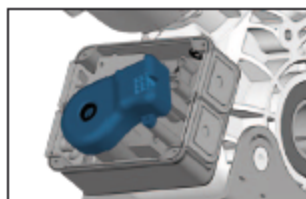

Flange bracket

ANSZXM

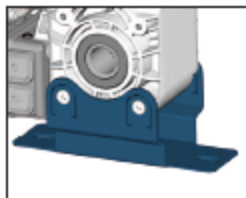

Base ment

AS0MBP

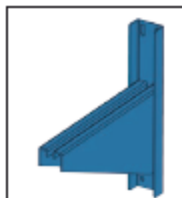

Bracket

AS0M

	LP50180TM		LP40130TM		LP60130TM		LP6090TM		LP7045TM	
Torque (Nm)	50		40		60		60		70	
Output speed (rpm)	180		130		130		90		45	
Frequency (Hz)	50		50		50		50		50	
Power supply (3~ Vac)	400	230	400	230	400	230	400	230	400	230
Power (kW)	0.65	0.8	0.9	0.96	0.65	0.8	0.95	0.96	0.95	0.96
Absorption (A)	1.7	3.5	2.4	4.4	1.7	3.5	2.5	4.2	2.5	4.2
Max cycles per hour	60		60		60		45		30	
Working temperature	-5°C/+40°C		-5°C/+40°C		-5°C/+40°C		-5°C/+40°C		-5°C/+40°C	
Protection rate (IP)	54		54		54		54		54	

	LP9090TM		LP12045TM		LP12590TM		LP25060TM	
Torque (Nm)	90		120		125		250	
Output speed (rpm)	90		45		90		60	
Frequency (Hz)	50		50		50		50	
Power supply (3~ Vac)	400	230	400	230	230	230		
Power (kW)	0.76	0.85	0.7	1.3	1.35	1.40		
Absorption (A)	1.9	3.6	1.8	3.4	6.2	6.4		
Max cycles per hour	45		30		45		40	
Working temperature	-5°C/+40°C		-5°C/+40°C		-5°C/+40°C		-5°C/+40°C	
Protection rate (IP)	54		54		54		54	

# RAPIDO

DIMENSIONS  
(mm)

LP9090TM / LP12045TM

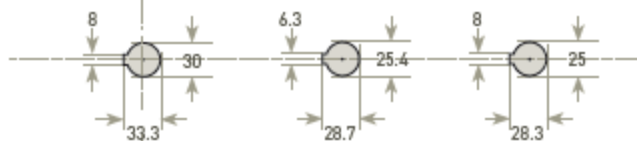
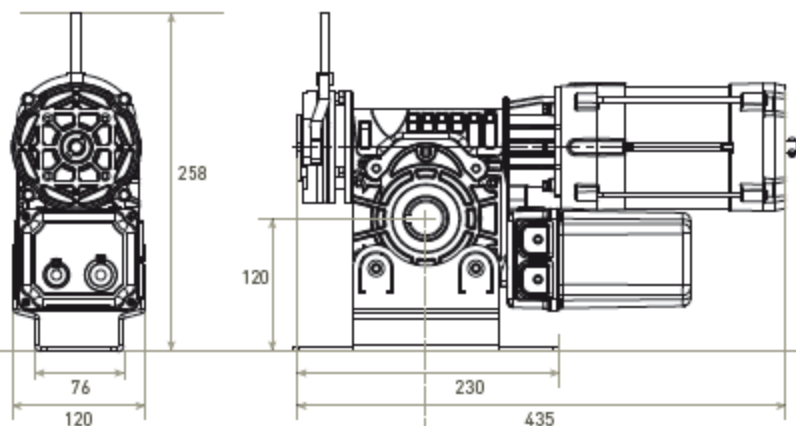

LP50180TM / LP40130TM

LP60130TM / LP6090TM

LP7045TM

